

BILL OF MATERIALS				REVISIONS			
ITEM #	PART #	QNTY	DESCRIPTION	REV	DESCRIPTION	APPRVD	DATE
1	2201012000	6	SEL MVG FINGER SET w/ HDW	A	ADDED OEM #S AND ISO VIEWS ADD REF TO OEM NUMBER ON ITEMS 4, 5, 6 & 8, CORRECT OEM NUMBER ON ITEMS 1, 2, 3, 5, 6, 7, 10 & 11, REV BOM DESC'S & UPDATE TITLE BLOCK CHG ITEM 1 OEM # (WAS F5121P0005) & ITEM 3 (WAS F5121P0004)	<b>RB</b>	01/17/06
2	2201022110	24	MAIN FIXED CONTACT BLADE	B		<b>RB</b>	09/02/14
3	2201013200	6	UPDATE COLLECTOR FGR SET				
4	2201011000	3	REV HINGE ASSY w/ HDW				
5	2201021225	3	REV RH STATIONARY w/ SLOT	C		<b>RB</b>	12/29/14
6	2201021226	3	REV LH STATIONARY w/ SLOT				
7	2201010010	12	ARCING BUTTON ASSY				
8	2201010105	6	XFER SW ROLLER ASSY w/ INLAY				
9	2201011235	12	XFER SWITCH MAIN STATIONARY				
10	2201013025	3	INNER COLLECTOR RING				
11	2201013026	3	OUTER COLLECTOR RING				

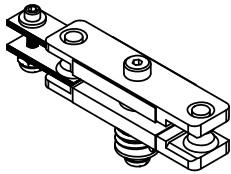

ITEM # 1  
OEM # W-5121-P-0817B (REF)  
(KIT #11 ONE PHASE)  
NMC # 2201012000

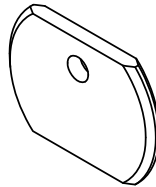

ITEM # 2  
OEM # W5121A0446  
NMC # 2201022110

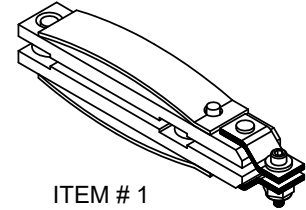

ITEM # 1  
OEM # W-5121-P-0818 (REF)  
(KIT #12 ONE PHASE)  
NMC # 2201013200

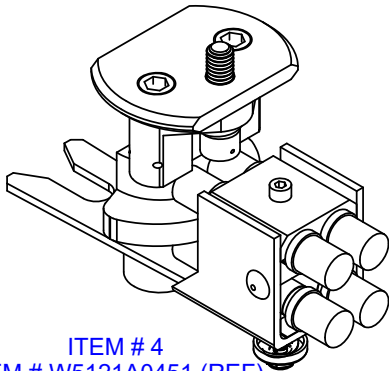

ITEM # 4  
OEM # W5121A0451 (REF)  
NMC # 2201011000

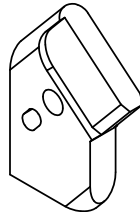

ITEM # 5  
OEM # W5121B05342 (REF)  
NMC # 2201021225



ITEM # 6  
OEM # W5121B05341 (REF)  
NMC # 2201021226

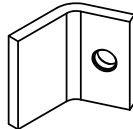

ITEM # 9  
NMC # 2201011235

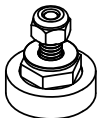

ITEM # 7  
OEM # 51210826A  
NMC # 2201010010

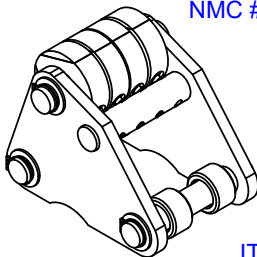

ITEM # 8  
OEM # W5121P0811 (REF)  
NMC # 2201010105

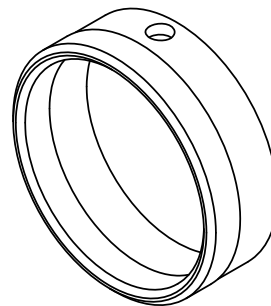

ITEM # 10  
OEM # W5121A0449A  
NMC # 2201013025

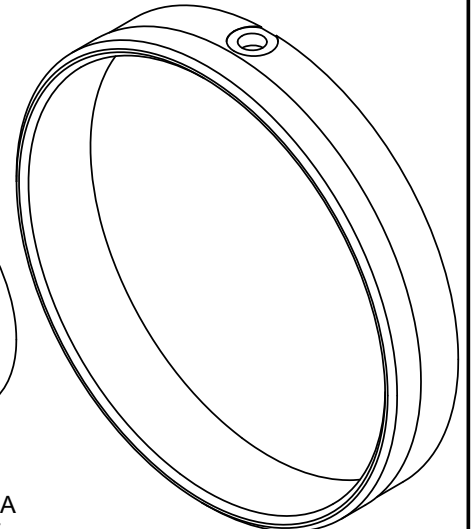

ITEM # 11  
OEM # W5121A0449B  
NMC # 2201013026

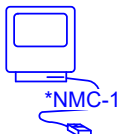

\*NMC-1

<b>NORMANDY MACHINE COMPANY INC.</b> 815 EAST CHERRY STREET, TROY MISSOURI 63379		MANUFACTURER FEDERAL PACIFIC
FEDERAL PACIFIC TC-15 & 25 1200 AMP COMPLETE TAP KIT		MAN. PART NO.
DRWG. NO. 2201000000		TYPE TC-15 & 25
		EQUIPMENT RATING 1200A